



## DATA SHEET FOR FLP FLEXIBLE METALLIC CONDUIT

### TECHNICAL DATA:

|                     |  |
|---------------------|--|
| PRODUCT             | : CAT NO: FH / 199   |
| ENCLOSURE           | : FLAME PROOF (Ex -d ), Gas Group IIA , IIB<br>As per IS/IEC 60079-1 : 2014      |
| PROTECTION          | : WEATHER PROOF IP – 66 AS PER IS/IEC 60529:2001<br>(Reaffirmed 2014)            |
| AREA CLASSIFICATION | : Ex db IIA IIB Gb ( EX tb / tc IIIC T85 C Db/Dc<br>(ZONE 1 & 2 & Zone 21 & 22 ) |
| CERTIFICATION       | : CIMFR, BIS , PESO  |
| MATERIAL            | : STAINLESS STEEL.   |
| GASKET              | : 'O' RING ENDLESS GASKET NEOPRENE / SILICON                                     |



### SELECTION CHART

| SR.NO | PARTICULAR                                  | OPTIONS             |
|-------|---|---------------------|
| 1.    | M 20 / ½ " NPT / ¾ " ET / EQUIVALENT        | 10000 MM / 10 METER |
| 2.    | UPTO M 50 / 1 ½ " NPT / 2 " ET / EQUIVALENT | 3000 MM / 3 METER   |

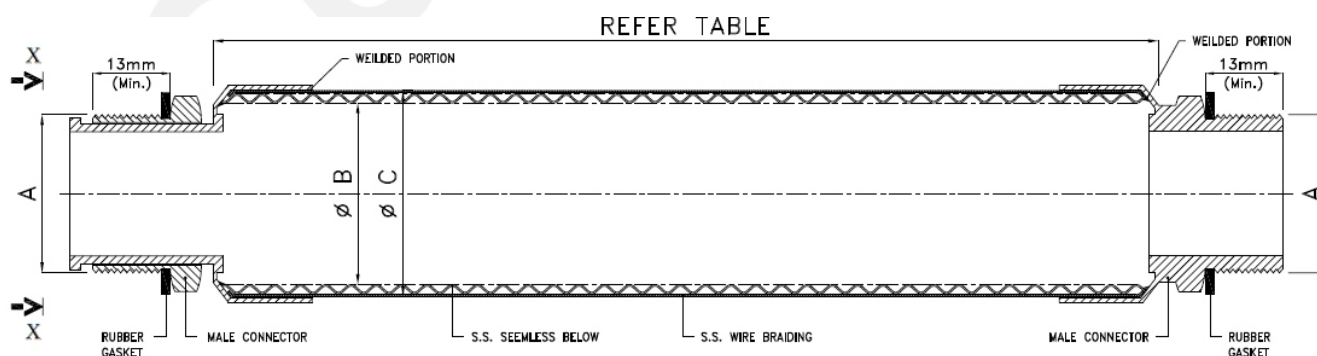
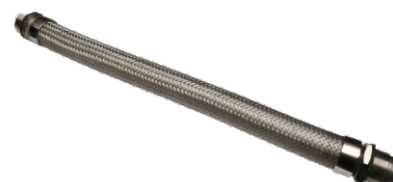

SECTIONAL VIEW OF FLEXIBLE CONDUIT

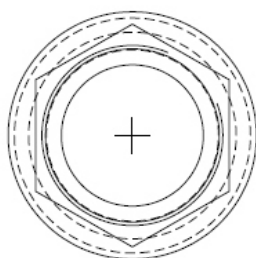

VIEW FROM -- 'X'

| DRG. No. | A (NIPPLE SIZE)                            | B       | C       | Maximum Length |
|----------|--|---------|---------|----------------|
| FH/199   | M20 / 1/2" NPT / EQUIVLENT 3/4" ET THREADS | 11mm ±2 | 20mm ±2 | 10000mm        |
| FH/199   | M50 / 1 ½" NPT / EQUIVLENT 2" ET THREADS   | 50mm ±2 | 68mm ±2 | 3000mm         |